

LOWER_BACK_PART
Fabric type TOP_FABRIC, CUT = (1, 0)
M=168-92-76, 0001-100

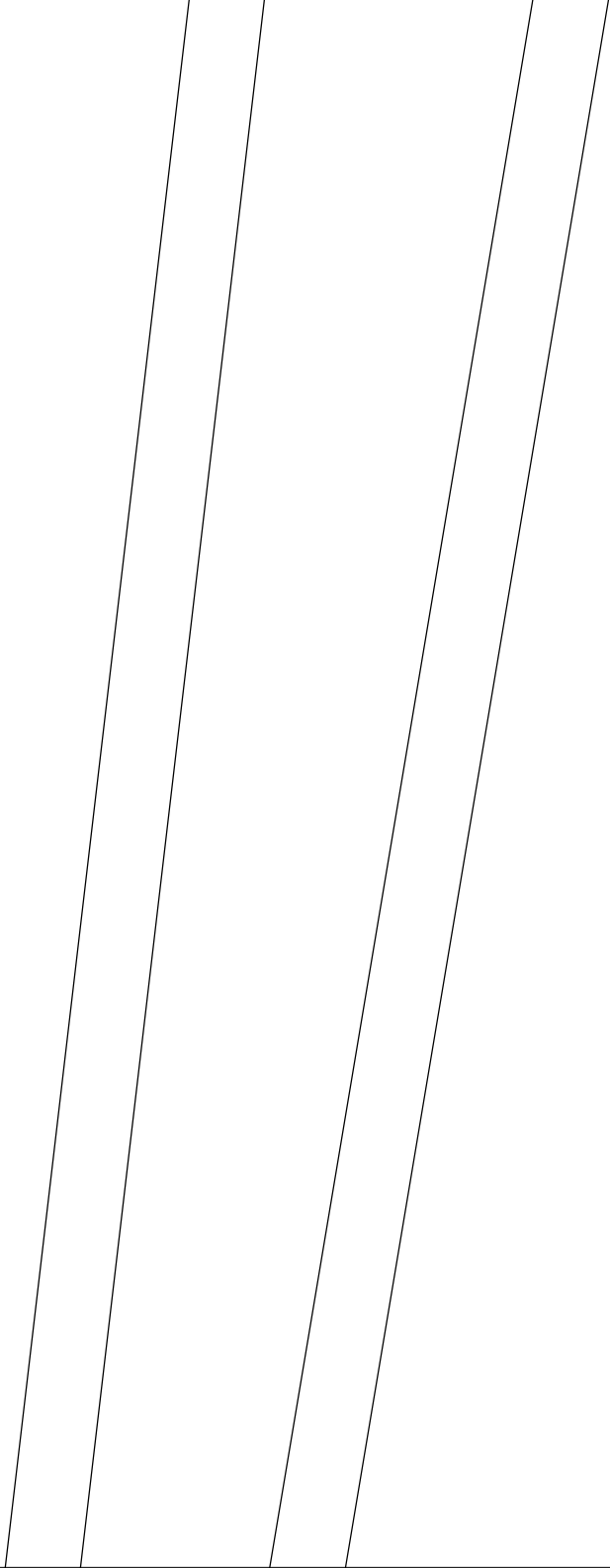

LOWER_

Fabric

W=168-

FRONT_PART

type TOP_FABRIC, CUT =(1,0)

92-76.0001-100

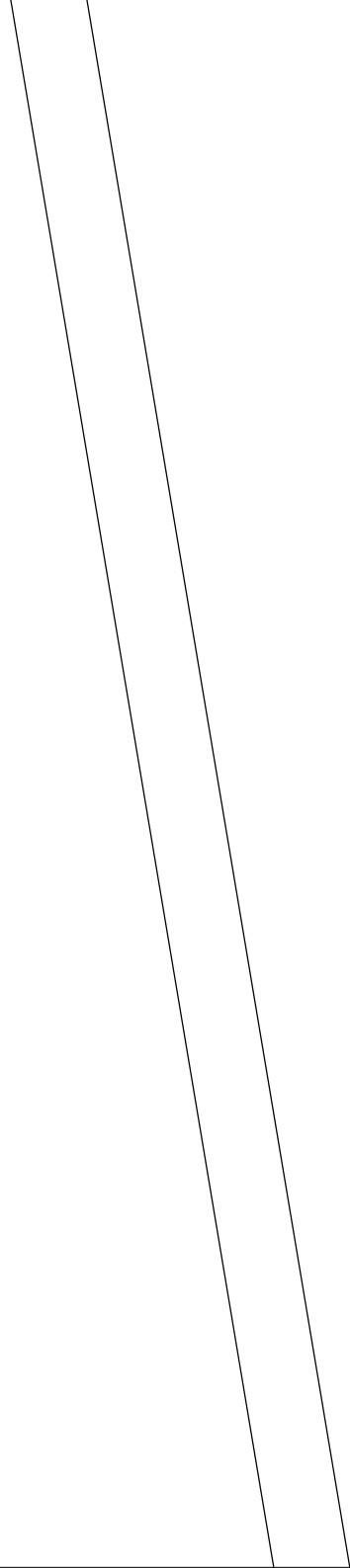

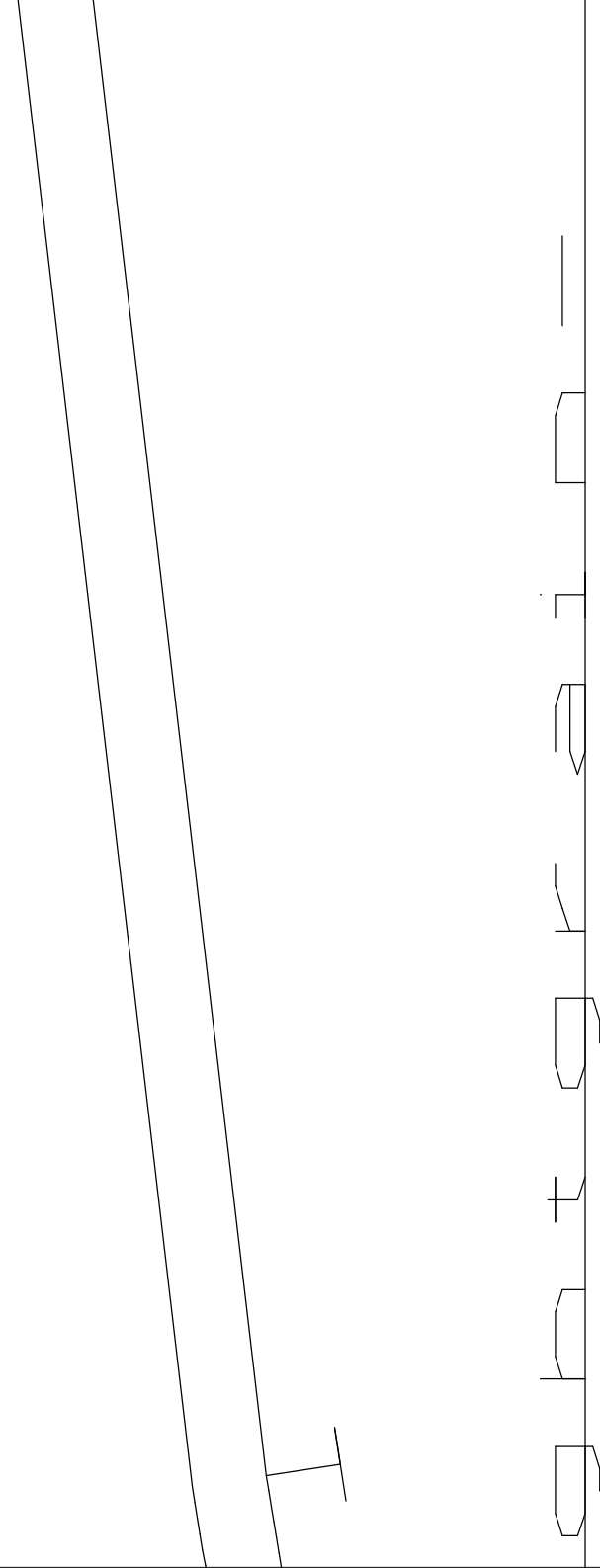



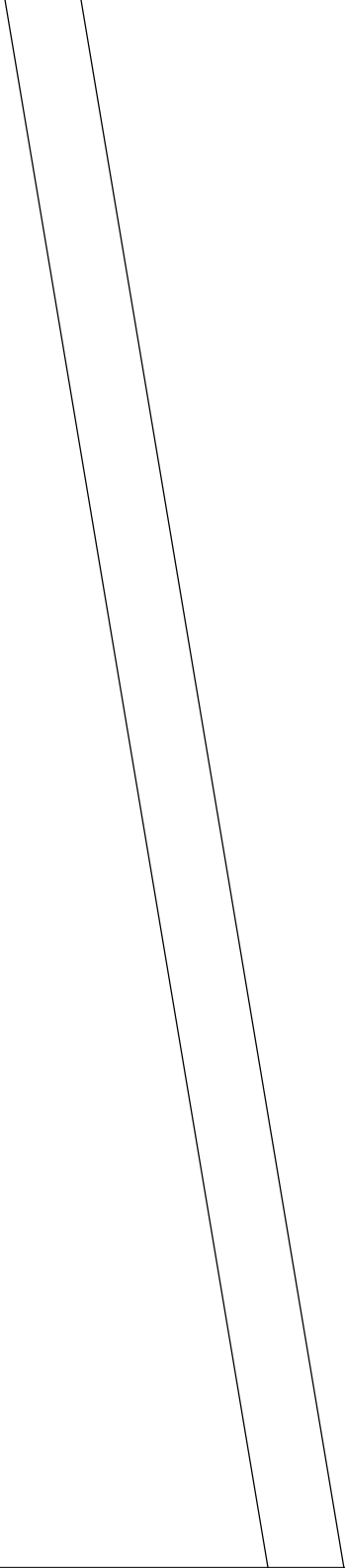
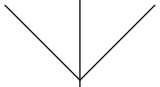



STK

STK

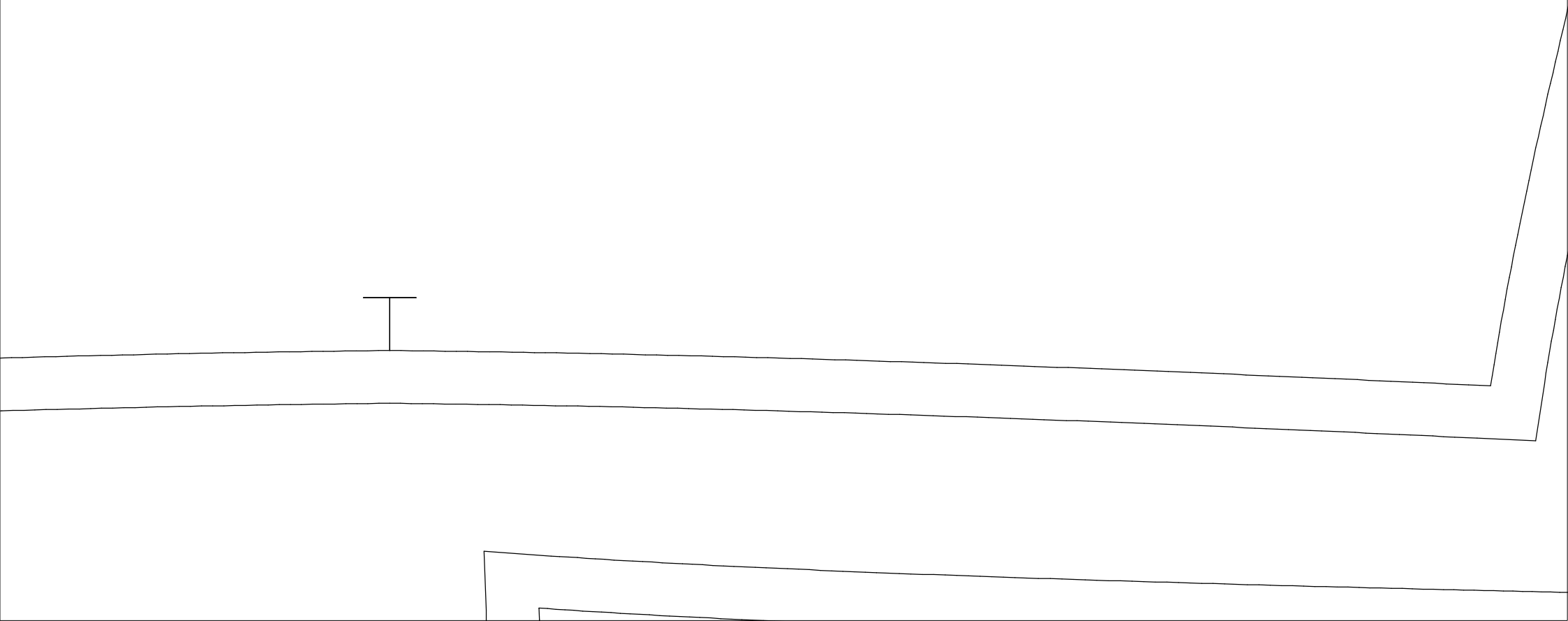

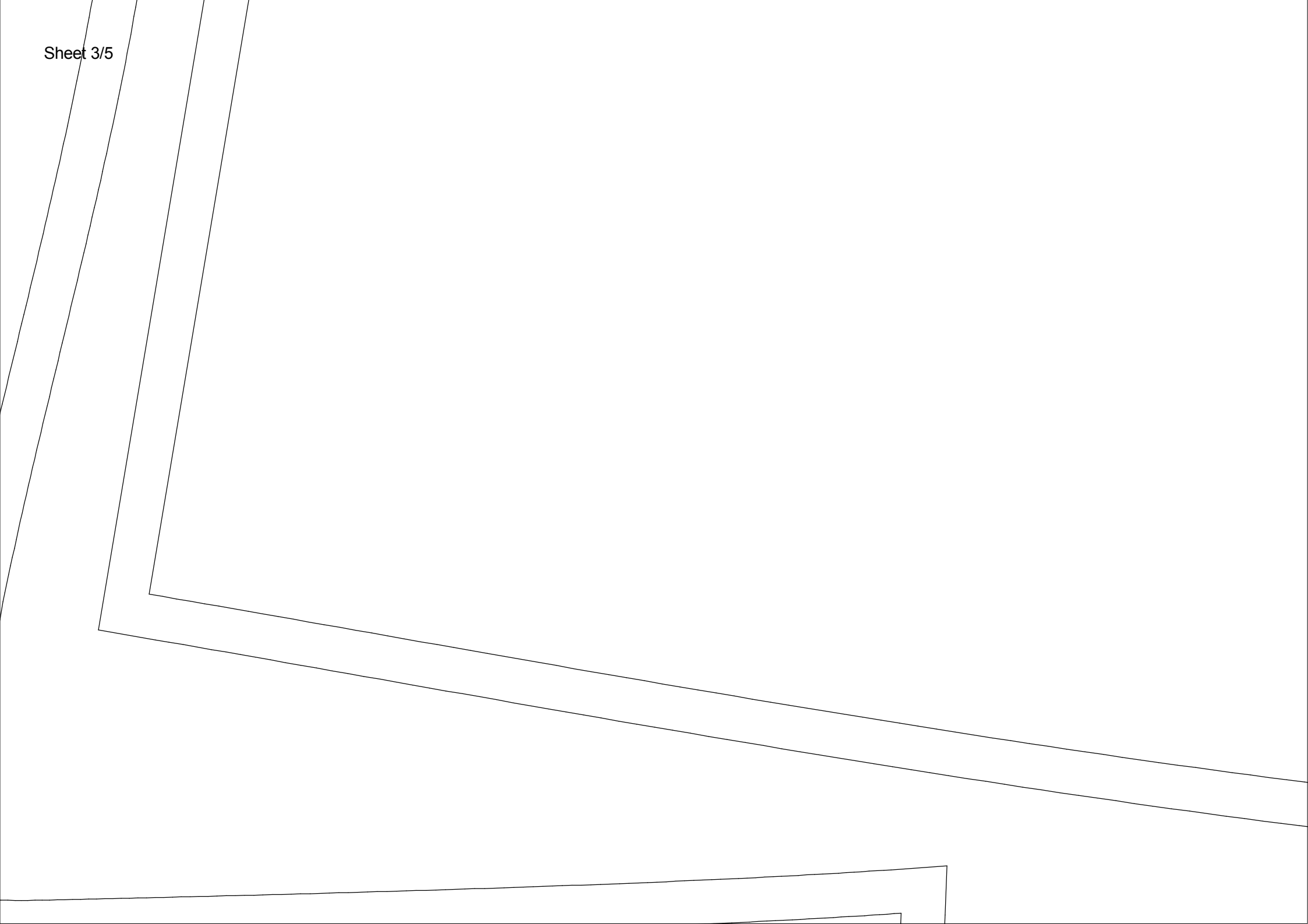

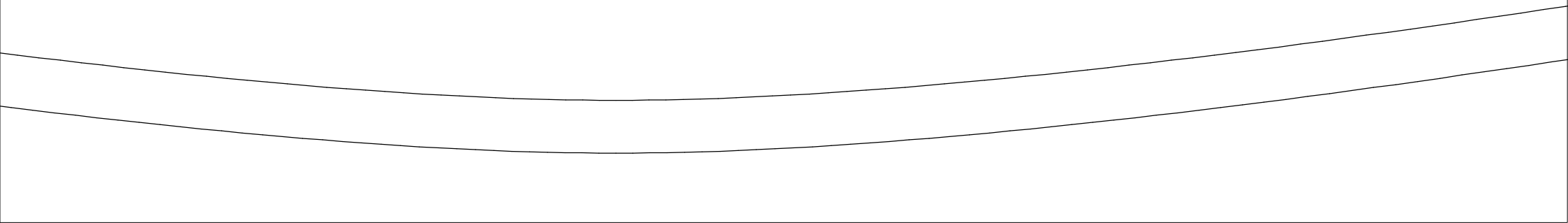

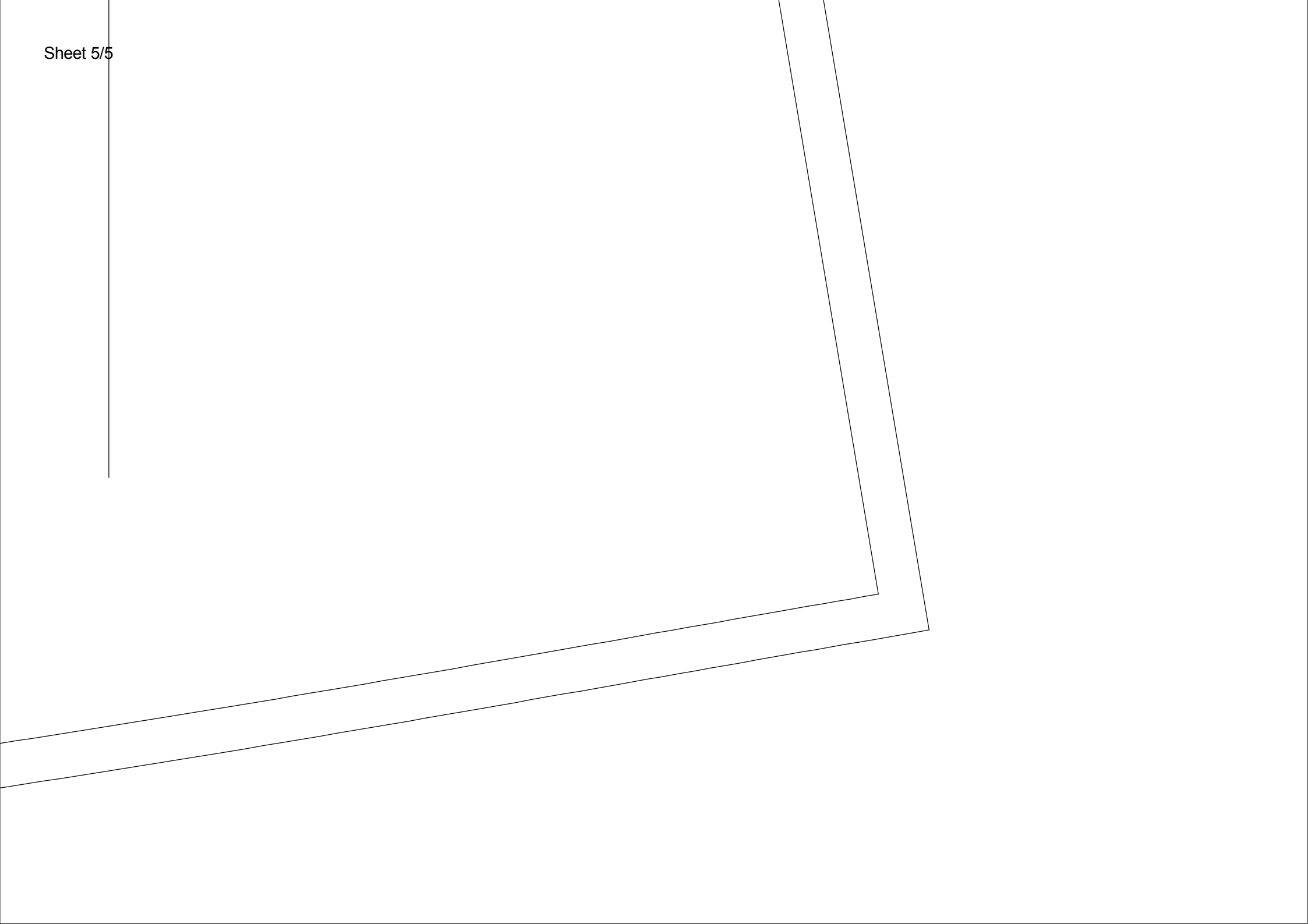

11910701101

UPPER_FRONT_PART

Fabric type TOP_FABRIC, CUT =(1,1)

W=168-92-76.0001-100

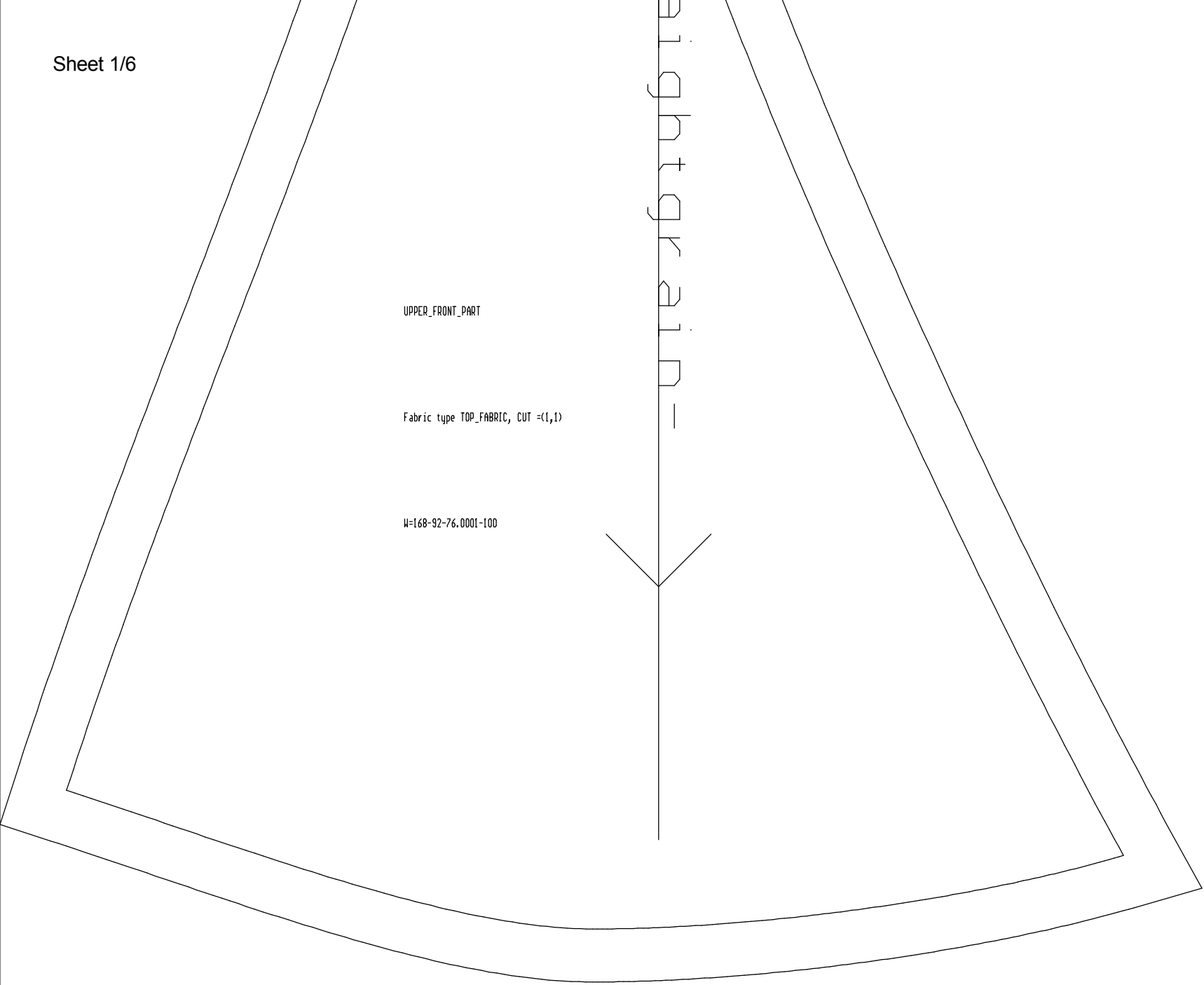
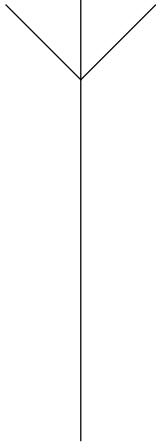

-Straight grain-

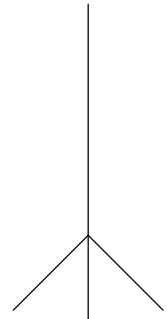

$\langle 0 \downarrow \rangle =$

M=168-92-76.00001-100

Fabric type TOP_FABRIC, CUT

BACK_MIDRIFF

FRONT_MIDRIFF

Fabric type TOP_FABRIC, CUT

W=168-92-76.0001-100

$$= \langle 1, 0 \rangle$$

-Straight grain-

